

**STEPHEN RAY FELLMAN  
ARCHITECT, A.I.A.**  
570 BROADWAY, AMITYVILLE  
NEW YORK 11701

TEL: (631) 789-3555  
FAX: (631) 789-3218  
EMAIL: MAIL@SRFAA.COM

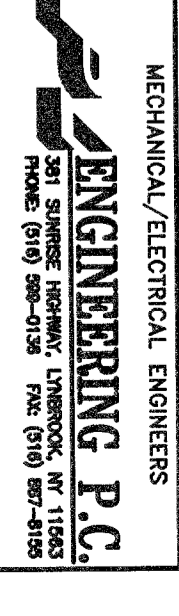

**ENGINEERING P.C.**  
281 SUTHERLAND AVENUE, DANBURY, CT 06810  
PHONE (910) 886-0156

NO.	DATE	REVISION	BY
	9/11/07	REVISED UL DETAIL	
	7/24/07	ISSUED FOR PERMIT	
	7/23/07	ISSUED FOR BID	
	6/6/07	MEETING	
	5/7/07	REVISED PER OWNER	JTW
	3/27/07	ISSUED TO CLIENT	JTW
	3/21/07	ISSUED TO CLIENT	JTW

SEAL:

IT IS A VIOLATION OF THE LAW FOR ANY PERSON, UNLESS ACTING UNDER THE DIRECTION OF A LICENSED ARCHITECT, TO ALTER AN ITEM IN ANY WAY.

PROJECT TITLE:  
**PROPOSED  
LIBRARY EXPANSION**

**DOWLING  
COLLEGE**

(BROOKHAVEN CAMPUS)  
BUILDING "A"

AT  
SHIRLEY, NY 11769

TOWN OF BROOKHAVEN  
SUFFOLK NEW YORK

SCITM: 0200-710-1-1.003

DRAWN BY: JTW

CHECKED BY: SRF

FILE NO.: ---

PROJ. NO.: 10033

DWG. NO.:

**A-2.3**

SECOND FLOOR  
FURNITURE PLAN

DWG. TITLE:

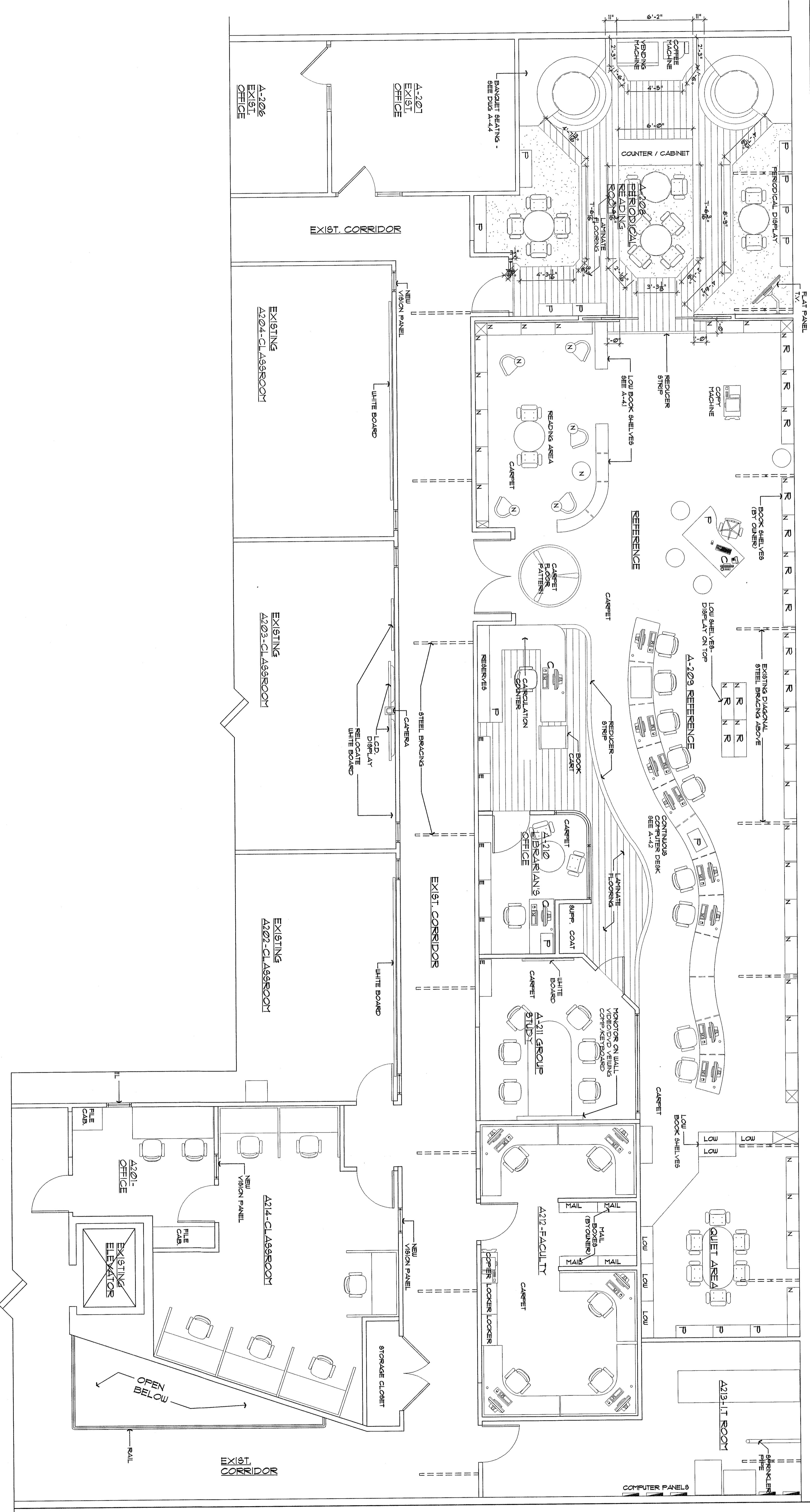

NOTE:  
ALL COMPUTER/SERVER EQUIPMENT  
RACKS TO BE RELOCATED  
BY DOWLING COLLEGE

NOTE:  
CONTRACTOR TO COORDINATE WITH OWNER  
ALL SHELVING, DESKS, HARDWARE, ETC.

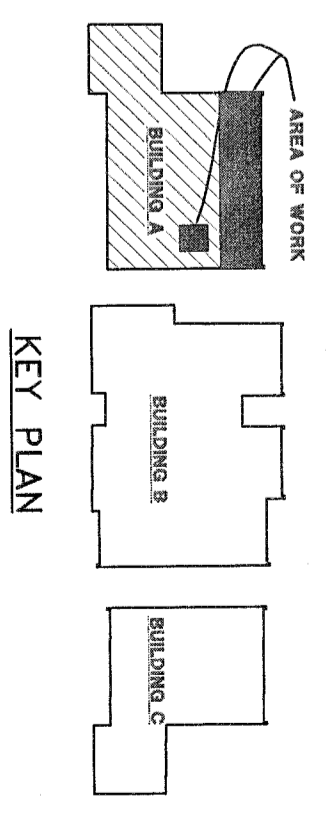

1  
A-2.3  
**FURNITURE PLAN**  
1/4" = 1'-0"